



LINTMAN

ÜLDPAIGALDUSJUHEND LIHTVANNIDELE

EST/ENG

1. Pange valmis tööriistad ning eemaldage toode pakendist



2. Asetage vann soovitud kohale ning reguleerige selle jalad ühele kõrgusele

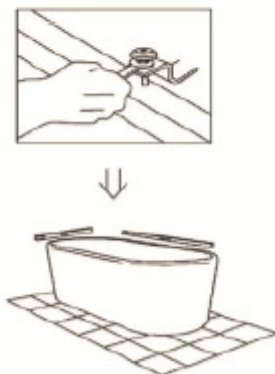

3. Asetage vann ettevaatlikult ühele küljele ning ühendage selle äravool



4. Täitke vann veega, testimaks võimalikke lekkeid

5. Lekete esinemisel tihendage äravool keerмениidi või silikooniga.

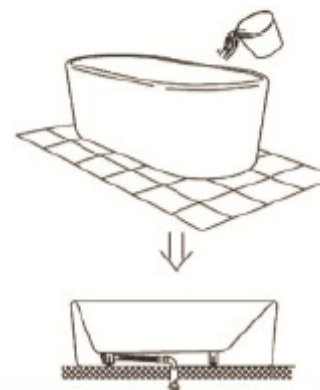

HOIATUS! Vältimaks vannile kriimude tekkimist - asetage paigaldamise ajaks vanni alla pehme materjal (vaip, ohituspapp).



1. Prepare the tools and take the bathtub out of the carton

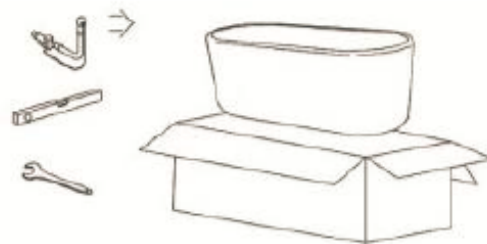

2. Place the bathtub to a desired place and adjust the adjustable legs at the same level

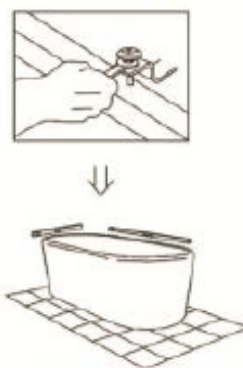

3. Place the bath on one side and connect the drain



4. Fill the tub with water in order to test it for leaks

5. In case of leakage, the drain can be fixed with a thread or silicone.

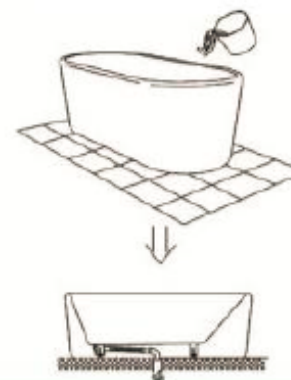

WARNING! To avoid the bath to be scratched – put it on a soft material during the installation (carpet, construction cardboard).